

# WM

Sunnex WM is a series of machine mounts specifically designed for the installation and leveling of medium to heavy-duty machines in industries such as plastics, engineering, and graphics.

The Sunnex WM mount features high precision leveling wedges that allows for effortless height adjustment with an accuracy of up to 1/100 mm. Thanks to its intelligent design, no fixing points are required. The mount can be placed anywhere under the machine and easily leveled afterward due to its wedge construction.

## Features

- Loads up to 6500kg per machine mount
- Painted design
- High friction Nitrile rubber mixture
- Free standing

## Applications

- Manufacturing industry
- Process industry
- Press and stamping machines
- Extrusion machines

## Benefits

- Precise levelling
- Great friction to surface
- Excellent versatility
- Choice of rubber thickness possible



## Technical specification WM

Rubber:	Nitrile rubber, high friction
Finish:	Painted
Load capacity:	850-6500kg
Key grip, A:	13-22mm
Height, H:	34-56mm
Length, L:	105-200mm
Width, B:	55-200mm

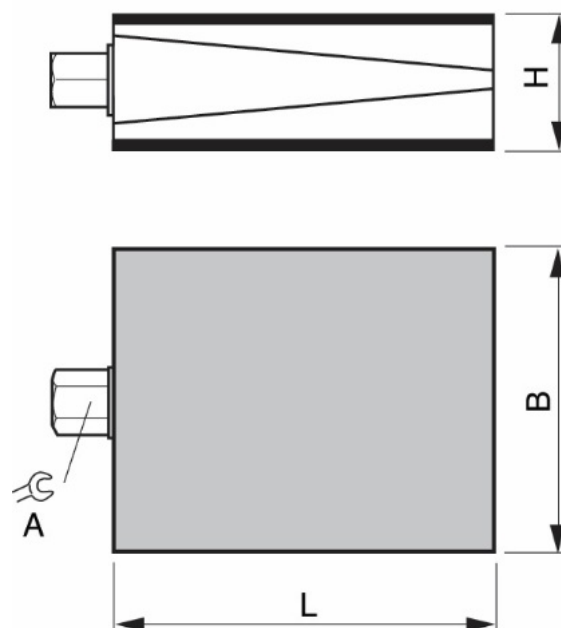

Model	Load mount daN (kg)	L mm	B mm	H mm	A mm	Part no.
<b>WM 10</b>	Up to 850	105	55	34-42	13	<b>47004</b>
<b>WM 20</b>	Up to 1800	150	75	37-47	19	<b>47007</b>
<b>WM 30</b>	Up to 3500	200	95	44-56	22	<b>47010</b>
<b>WM 40</b>	Up to 6500	200	200	46-58	22	<b>47016</b>