

# SUNNEX WM

Sunnex WM is a series machine mounts specially designed for installing and levelling of medium and heavy-duty machines used in areas such as the plastic-, engineering- and graphics industry.

The Sunnex WM system consists of a high precision levelling wedge, that thanks to a simple levelling procedure enables height adjustment with an accuracy of up to 1/100 mm.

No fixing points are needed thanks to the well thought out design. It can be placed anywhere under the machine and be levelled subsequently thanks to the wedge construction.

## Preferences

- Loads up to 6500kg, per machine mount
- Painted design
- High friction Nitrile rubber mixture
- Free standing

## Applications

- Manufacturing industry
- Process industry
- Press- & stamping machines
- Extrusion machines

## Advantages

- Excellent levelling
- Excellent friction to surface
- Excellent versatility
- Choice of rubber thickness possible

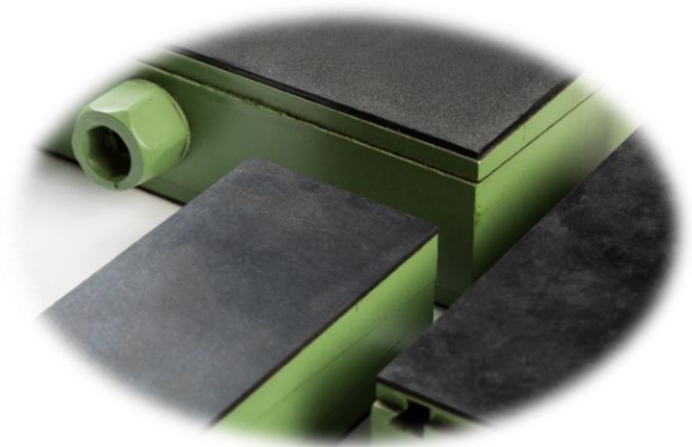

## Technical specification WM

Rubber:	Nitrile rubber, high friction
Finish:	Painted
Load capacity:	850-6500 kg
Key grip, A:	13-22 mm
Height, H:	34-56 mm
Length, L:	105-200 mm
Width, B:	55-200 mm

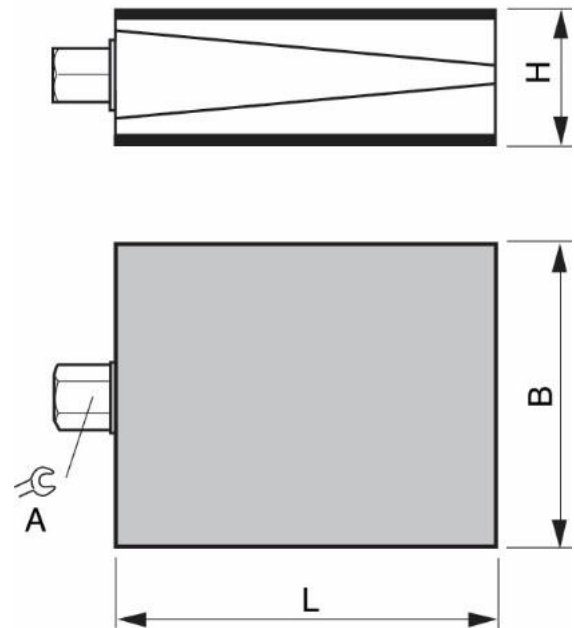

Model	Load mount daN (kg)	L mm	B mm	H mm	A mm	Part no.
<b>WM 10</b>	Up to 850	105	55	34-42	13	<b>47004</b>
<b>WM 20</b>	Up to 1800	150	75	37-47	19	<b>47007</b>
<b>WM 30</b>	Up to 3500	200	95	44-56	22	<b>47010</b>
<b>WM 40</b>	Up to 6500	200	200	46-58	22	<b>47016</b>