

# SLM

SLM-series is a magnifying luminaire with LED lamps fitted in a circular pattern around the magnifying lens.

LED enables a long service life and low temperature impact on inspected subjects.

Suitable for light industry. Typical applications are: Labs, control stations and precision mechanics.

## Features

- LED service life >25000h
- 80 LED's , 8W
- Balanced arm system with table clamp
- Incorporated cover for magnifying lens
- Magnifying lens 5 diopters (2,25X)

## Applications

- Laboratories
- Control stations
- Precision work

## Benefits

- Low power consumption
- Easy to operate balanced arm system

## Technical specifications

Supply voltage	220-240V AC 50Hz, 1,6m cordset
Power consumption	8W
Arm length	400 x 400mm
Colour	White
Colour temperature	6500K
IP-rating	IP20
Protection class	II
Light output	500Lm
Colour rendering index	80
Weight	2,3kg
Life span	25000h
Table clamp	Gap: 64mm

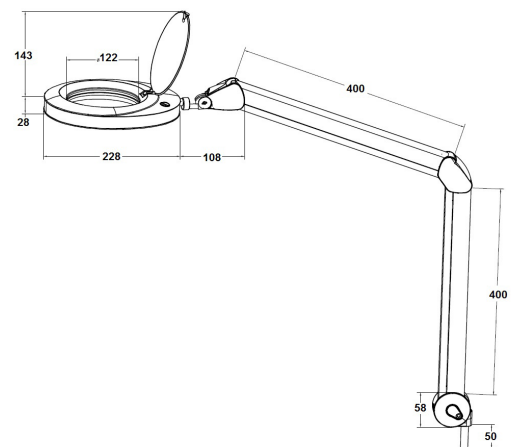

Arm	Connection	Version	Part no.
400x400mm	220-240V AC	IP20	31100